



UNIVERSAL MULTI MOWER

ZW Series



MOST UNIVERSAL MOWER OPTION

ZW multi mowers have a hydraulic offset possibility of 165 cm / 5'5" (front models 110 cm / 3'7") and can work both partially behind the tractor and fully offset. The working range of the cutting head is hydraulically adjustable from +90° to -60°.

This mower is ideal for topping, estate maintenance, field borders, ditches, embankments, hedges etc., cutting around trees and other obstacles on the verge with minimum tractor road width required because of the large offset.

*Reinforced multi mower.
Most universal choice for all your mowing jobs.*



ZW SERIES

Universal multi mowers



The headstock incorporates a spring protected safety breakaway system that allows the cutting head to pivot clear and reset automatically in case of a collision.

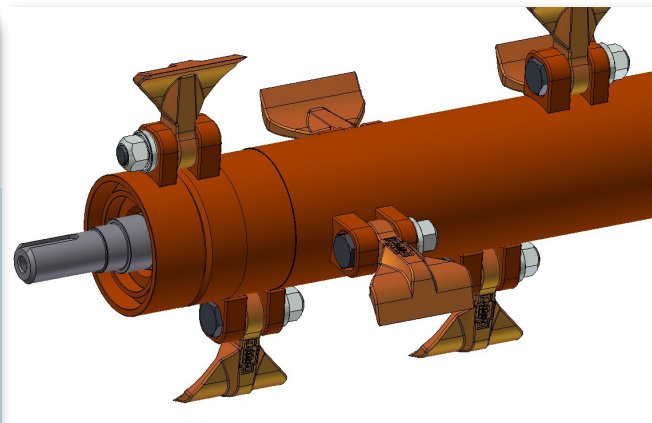

The 0,9 kg (2 lbs) special flails with single cutting edges ensure clean and finest cut of grass, rushes, reed stems, pruning etc. up to 3 cm. They are fitted to the double balanced rotor with heavy 20 mm bolts and replaceable steel bushes. Flex-flails, specially designed for terrain with a lot of (large) stones are optionally available.

HEAVY DUTY HEADSTOCK

"PERFECT" has designed a special heavy-duty headstock with reinforcements at key points and offset device to transmit the weight of the cutting head to the tractor.



EXTRA'S

- Front mount model
- Left hand model
- Flex-flails

Technical specifications	ZW-150	ZW-180	ZW-210	ZW-240
Working width (cm/ inch)	150/ 4'9"	180/ 5'9"	210/ 6'9"	240/ 7'9"
Speed:				
- PTO shaft (rpm)	540	540	540	540
- flail shaft (rpm)	2075	2075	2075	2010
Required min. power (kW/ HP)	37/ 50	44/ 60	51/ 70	59/ 80
Flails 0.9 kg = 1.98 lb	16	18	22	24
Transport width (cm/ inch)	140/ 4'6"	140/ 4'6"	140/ 4'6"	140/ 4'6"
Tractor coupling system (cat.)	II	II	II	II
Weight (kg/ lb)	735/ 1620	780/ 1720	840/ 1852	900/ 1984
Offset from tractor centre:				
- minimum (cm/ inch)	100/ 3'2"	130/ 4'2"	160/ 5'2"	190/ 6'2"
- maximum (cm/ inch)	255/ 8'4"	285/ 9'4"	315/ 10'3"	345/ 11'3"
Offset from tractor centre (front-mounted):				
- minimum (cm/ inch)	115/ 3'8"	145/ 4'8"	175/ 5'7"	205/ 6'7"
- maximum (cm/ inch)	225/ 7'4"	255/ 8'4"	295/ 9'7"	315/ 10'3"

As our policy is one of continuous improvement, we reserve the right to change the specification or to modify the design without prior notice



Van Wamel B.V.

📍 Van Wamel B.V.
Energieweg 1, 6658 AE
Beneden Leeuwen
The Netherlands

☎ +31 (0) 487 59 29 44
☎ +31 (0) 487 59 29 44
@ www.vanwamel.nl
🌐 perfect@vanwamel.nl

Your PERFECT dealer