



# HEAVY DUTY FLAIL MOWER

**KT Series**



## **EXCELLENCE PERFORMANCE**

The "Perfect" KT Heavy-Duty Flail Toppers have a spacious and heavy body to deal with longer and/or more dense vegetation in fallow land and set-aside land, for cornstalks etc.

They are intended for the professional customer who needs a versatile and reliable implement that provides an excellent performance, even under heavier conditions, at very low maintenance costs.

*Versatile and heavy duty flail mowers.  
Ready for the toughest job around your farm.*





## KT SERIES

# Heavy duty flail mowers



To protect the bearings of the large diameter rear roller, the bearings are fitted with unique covers to prevent humidity, dust and mud from entering.

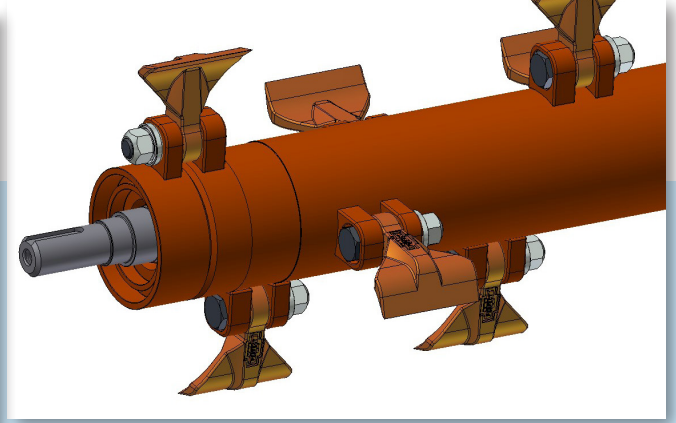

The 0,9 kg (2 lbs) special flails with single cutting edges ensure clean and finest cut of grass, rushes, reed stems, pruning etc. up to 3 cm. They are fitted to the large diameter double balanced rotor with with heavy 20 mm bolts and replaceable steel bushes. 2,2 kg universal flails, or Combi-flails are optional available.

### ADJUSTABLE REAR HOOD

An easily adjustable rear hood is standard. Its different positions vary the degree of debris mulching against the comb section counter knives.

### PULLED TYPE FRONT MOUNT HEAD STOCK

The unique cantilever design of the headstock enables the front mounted version of the "Perfect" flail chopper to be pulled rather than pushed. This protects the machine and provides a full floatation effect. For combination with a plough PERFECT supplies their unique 3-D flex head stock.

### EXTRA'S

- Front mount model
- 3D-Flex front mount model
- Parallelogram-type offset feature (mechanical or hydraulic)
- 2,2 kg universal flails
- 2,7 kg Combi-flails
- Pro-fix flail mounting
- Wearing plates

As our policy is one of continuous improvement, we reserve the right to change the specification or to modify the design without prior notice

Technical specifications	KT-245	KT-270	KT-300	KT-320
Working width (cm/ inch)	245/ 8'0"	270/ 8'9"	300/ 9'8"	320/ 10'5"
Speed:				
- PTO shaft (rpm)	1000	1000	1000	1000
- flail shaft (rpm)	2100	2100	2100	2100
Required min. power (kW/ HP)	40/ 55	48/ 65	55/ 75	62/ 85
Flails 0.9/ 2.2 (kg) - 1.98/ 4.85 (lb)	24/ 16	28/ 16	32/ 18	32/ 20
Total width (cm/ inch)	274/ 9'0"	299/ 9'8"	329/ 10'8"	349/ 11'5"
Tractor coupling system (cat.)	II	II	II	II
Weight (kg/ lb)	900/ 1984	970/ 2138	1030/ 2271	1320/ 2910
Fixed 3-point offset from tractor centre (cm/ inch)	143/ 4'7"	168/ 5'5"	150/ 4'9"	160/ 5'2"
Hydraulic offset from tractor centre (optional):				
- minimum (cm/ inch)	115/ 3'8"	140/ 4'6"	122/ 4'0"	132/ 4'3"
- maximum (cm/ inch)	172/ 5'6"	197/ 6'5"	180/ 5'9"	190/ 6'2"



Van Wamel B.V.

📍 **Van Wamel B.V.**  
Energieweg 1, 6658 AE  
Beneden Leeuwen  
The Netherlands

☎ +31 (0) 487 59 29 44  
☎ +31 (0) 487 59 29 44  
@ www.vanwamel.nl  
🌐 perfect@vanwamel.nl

Your PERFECT dealer