



## FRONT AND REAR MOUNT FLAIL MOWER

### KR Series



#### **FRONT AND REAR WITHOUT TRANSFORMATION**

KR series flail mowers are fitted with a special headstock that fits both the tractor front- and rear linkage without any transformation. They are especially designed for heavier topping, on rough and overgrown land, fallow land etc.

The standard configuration includes a hydraulic side-shift of 48 cm = 19" and a unique gearbox, that accepts both RH and LH rotation, with integrated overrunning clutch.

*Universal front and rear mowers.  
Ready for every job around your farm.*

## KR SERIES

# Front and rear mount flail mowers



To protect the bearings of the large diameter rear roller, the bearings are fitted with unique covers to prevent humidity, dust and mud from entering.

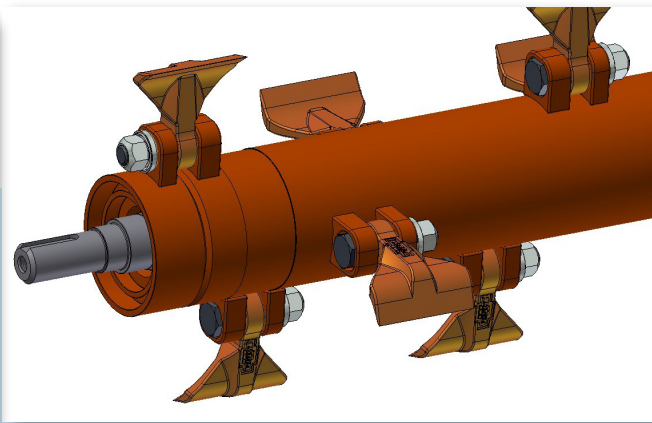

The 0,9 kg (2 lbs) special flails with single cutting edges ensure clean and finest cut of grass, rushes, reed stems, pruning etc. up to 3 cm. They are fitted to the double balanced rotor with with heavy 20 mm bolts and replaceable steel bushes.

### ROBUST CONSTRUCTION

The large diameter flail rotor is driven through an oil-bath gearbox. V-belts are kept at the right tension by springloaded automatic belt tensioners. This indirect flexible drive ensures maximum security and requires minimum maintenance.

### EXTRA'S

- Flex-flails instead of 0,9 kg (2 lbs) flails, for better protection against large stones

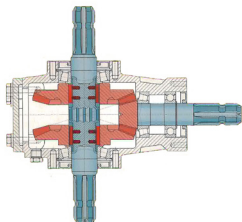

Technical specifications	KR-245	KR-270	KR-300
Working width (cm/ inch)	245/ 8'0"	270/ 8'8"	300/ 9'8"
Speed:			
- PTO shaft (rpm)	540	540	540
- flail shaft (rpm)	1890	1890	1890
Required min. power (kW/ HP)	33/ 45	40/ 55	48/ 65
Flails 0.9 (kg)/ 1.98 (lb)	24	28	32
Total width (cm/ inch)	261/ 8'6"	286/ 9'4"	316/ 10'4"
Tractor coupling system (cat.)	II	II	
Weight (kg/ lb)	930/ 2050	975/ 2150	1020/ 2249
Offset from tractor centre:			
- minimum (cm/ inch)	88/ 2'9"	113/ 3'7"	143/ 4'7"
- maximum (cm/ inch)	135/ 4'4"	160/ 5'2"	190/ 6'2"

As our policy is one of continuous improvement, we reserve the right to change the specification or to modify the design without prior notice